

The order of assembly:

1. Opening and placing of the clamp in the right level, on the column.
2. Closing of the clamp, placing the M10x20 flat washer (A2) and screwing of the M10x25 (A2) bolt with a spherical head and a star socket with pin

ATTENTION: Befor screwing of the bolt you must cover its thread with a glue ("loctite") for securing threads. The clamps must be assembled with a torque wrench (the value of torque = 45Nm).

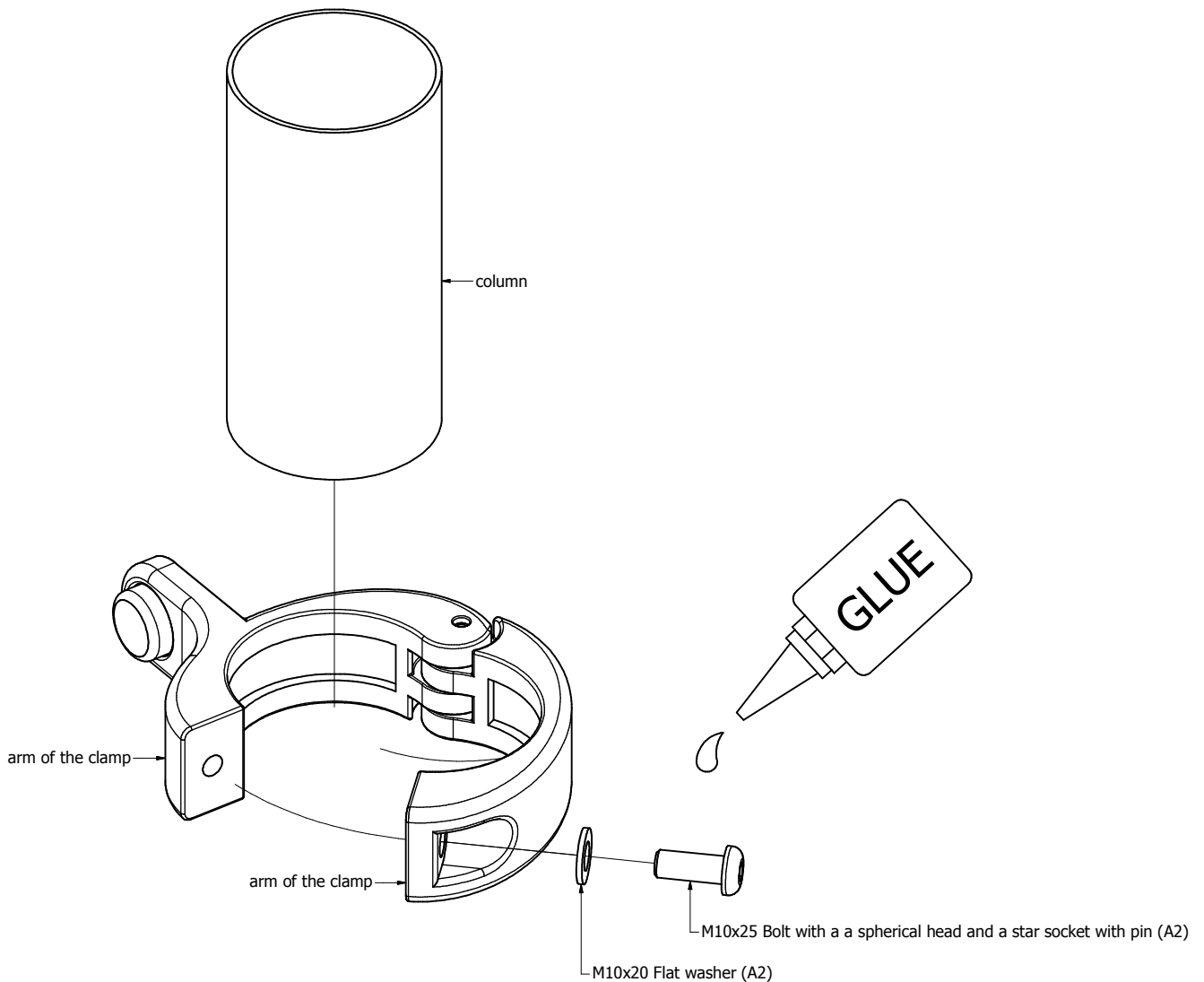

ATTENTION: After clamping the clamp on the post - the gap between clamp's arms must be less than 2mm.